

GENERAL TECHNICAL CHARACTERISTICS	
Reference standards :	IEC 61071 60068 60384
Climatic category:	40/85/56
Dielectric :	Polypropylene film
Construction :	Extended double-side metallized carrier film with internal series connection and metallized film
Features:	Low ESR, Low Ls, High current. High voltage. high stability. Self-healing
Coating :	Polyester tape wrapping; UL94V-0 resin end fill
Leads:	Treaded insert M6 or M8
ELECTRICAL CHARACTERISTICS	
Working temperature :	-40 to + 85°C (max hotspot≤70°C)
Storage temperature :	-40 to + 85°C
Capacitance :	0.04 to 6μF
Rated Voltage:	1200v to 5000Vdc
Dissipation factor:	<0.0005(1k Hz 20± 5°C)
Tolerance :	± 5%(J) ± 10%(K)
Life expectancy :	100,000 hours at Un and 70°C
TEST METHODS AND PERFORMANCES	
Test voltage between terminals and case :	3 KV 50Hz for 60 sec
Test voltage between terminals :	1.5Un applied for 10s at 25±5°C

Outline drawing:

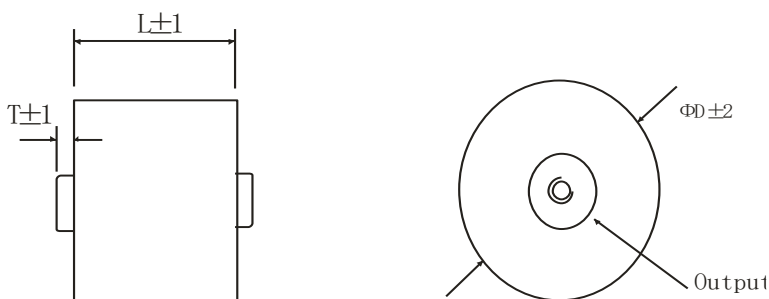

Electrical specifications, ordering codes

Part Number	CAP μF	Dimension (mm)				du/dt v/μs	Ipeak A	ESR@ 1.0kHz	Irms@25C @10kHz
		L	D	T	Output				
		Un1200Vdc		Urms 500Vac					
CSR1200K1.0-*-*#	1	37	35	5.0	M6	1100	1100	2.3	30
CSR1200K1.5-*-*#	1.5	37	42	5.0	M6	1100	1650	2.2	35
CSR1200K2.0-*-*#	2	37	48	5.0	M6	900	1800	2.1	40
CSR1200K2.5-*-*#	2.2	37	50	5.0	M6	900	1980	2.1	43
CSR1200K3.0-*-*#	3	37	58	5.0	M6	800	2400	1.8	47
CSR1200K3.3-*-*#	3.3	37	61	5.0	M6	800	2640	1.7	50
CSR1200K4.0-*-*#	4	37	67	5.0	M6	600	2400	1.6	56

Electrical specifications, ordering codes

Part Number	CAP μF	Dimension (mm)				du/dt v/μs	Ipeak A	ESR@ 1.0kHz	Irms@25C @10kHz
		L	D	T	Output				
Un1200Vdc Urms 500Vac									
CSR1200K3.0-*-*#	4.7	37	73	5.0	M6	600	2820	1.5	62
CSR1200K3.3-*-*#	5	37	76	5.5	M6	600	3000	1.4	65
CSR1200K4.0-*-*#	6	37	82	5.5	M6	600	3600	1.2	75
Un2000Vdc Urms 750Vac									
CSR2000K0.22-*-*#	0.22	37	38	5.0	M6	1500	330	2.8	27
CSR2000K0.3-*-*#	0.3	37	38	5.0	M6	1500	450	2.7	30
CSR2000K0.33-*-*#	0.33	37	38	5.0	M6	1500	495	2.7	32
CSR2000K0.4-*-*#	0.4	37	43	5.0	M6	1500	600	2.7	36
CSR2000K0.44-*-*#	0.44	37	45	5.0	M6	1500	660	2.6	38
CSR2000K0.47-*-*#	0.47	37	46	5.0	M6	1500	705	2.6	40
CSR2000K0.60-*-*#	0.6	37	51	5.0	M6	1500	900	2.5	45
CSR2000K0.7-*-*#	0.7	37	55	5.0	M6	1500	1050	2.4	48
CSR2000K0.9-*-*#	0.9	37	62	5.0	M6	1100	990	2.3	52
CSR2000K1.0-*-*#	1.0	37	65	5.0	M6	1100	1100	2.2	55
Un3000Vdc Urms 1200Vac									
CSR3000K0.2-*-*#	0.2	40	43	5.0	M6	1800	360	2.8	32
CSR3000K0.3-*-*#	0.3	40	52	5.0	M6	1800	540	2.6	38
CSR3000K0.4-*-*#	0.4	40	60	5.0	M6	1800	720	2.5	45
CSR3000K0.44-*-*#	0.44	40	62	5.0	M6	1800	792	2.5	48
CSR3000K0.47-*-*#	0.47	40	65	5.0	M6	1500	705	2.4	50
CSR3000K0.6-*-*#	0.6	40	73	5.0	M6	1500	900	2.2	58
CSR3000K0.65-*-*#	0.65	40	76	5.5	M6	1500	975	2.1	60
CSR3000K0.7-*-*#	0.7	40	79	5.5	M6	1500	1050	2	65
Un5000Vdc Urms 2000Vac									
CSR5000K0.04-*-*#	0.04	54	58	5.0	M6	3000	120	2.2	35
CSR5000K0.06-*-*#	0.06	54	66	5.0	M6	3000	180	2.2	45
CSR5000K0.08-*-*#	0.08	54	58	5.0	M6	3000	240	2.2	45
CSR5000K0.12-*-*#	0.12	54	70	5.0	M6	3000	360	2	50
CSR5000K0.14-*-*#	0.14	54	76	5.5	M6	3000	420	1.8	58
CSR5000K0.2-*-*#	0.2	54	90	5.5	M8	3000	600	1.6	65
CSR5000K0.22-*-*#	0.22	54	94	5.5	M8	3000	660	1.5	70

Part Numbering System: CSR5000K0.08-M6-54 "M6" = "M6 or M8" 54="Length"